

# INDUCTIVE AC

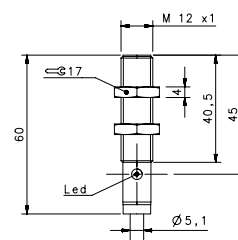

# INDUCTIVE AC M12

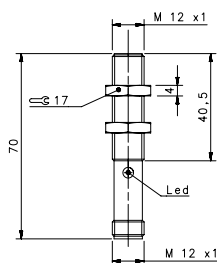

## STANDARD VAC

### FLUSH

#### NOMINAL SWITCHING DISTANCE

			M12 conn	cable
			2 mm	2 mm
10-30 Vdc	PNP/NPN NO-NC	4 wires	---	---
		order No.	---	---
10-30 Vdc	PNP NO	3 wires	---	---
		order No.	---	---
10-30 Vdc	PNP NC	3 wires	---	---
		order No.	---	---
10-30 Vdc	NPN NO	3 wires	---	---
		order No.	---	---
10-30 Vdc	NPN NC	3 wires	---	---
		order No.	---	---
10-30 Vdc	PNP NO-NC	4 wires	---	---
		order No.	---	---
10-30 Vdc	NPN NO-NC	4 wires	---	---
		order No.	---	---
10-30 Vdc	NO-NC	2 wires	---	---
		order No.	---	---
20-250 Vac/Vdc	NO	2 wires	---	---
		order No.	---	---
20-250 Vac/Vdc	NC	2 wires	---	---
		order No.	---	---
20-250 Vac	NO	2/3wires	IS-12-A15-S2	IS-12-A15-03
		order No.	95B060690	95B060680
10-30 Vdc	Analog 0-20 mA	3 wires	---	---
		order No.	---	---
NAMUR amplifier	NAMUR	2 wires	---	---
		order No.	---	---

<b>Nominal Voltage</b>	20+250 Vac (50,60 Hz)	20+250 Vac (50,60 Hz)
<b>Residual Ripple</b>	< 10%	< 10%
<b>Hysteresis</b>	< 10%	< 10%
<b>Max. Output Current</b>	500 mA, inrush:1,5A	500 mA, inrush:1,5A
<b>Min. Output Current</b>	20 mA	20 mA
<b>Residual Current</b>	< 0,7 mA	< 0,7 mA
<b>Voltage Drop</b>	< 4 V (I=100mA)	< 4 V (I=100mA)
<b>Operation Led</b>	Yellow	Yellow
<b>Switching Frequency</b>	25 Hz	25 Hz
<b>Start Up Delay</b>	< 300 ms	< 300 ms
<b>Repeatability</b>	5%	5%
<b>Short Circuit Protection</b>	Present (self-resetting)	Present (self-resetting)
<b>Electric Protection</b>	Against polarity reversal inductive loads	Against polarity reversal inductive loads
<b>Temperature Limit</b>	(-25 ... +70 °C)	(-25 ... +70 °C)
<b>Protection Degree</b>	IP67	IP67
<b>Cable Length</b>	---	2 m
<b>Cable Section</b>	---	2 x 0,25 mm²
<b>Housing Material</b>	Nickel-plated brass	Nickel-plated brass
<b>Active face</b>	PA 16	PA 16
<b>Tightening torque</b>	* see page 5 of the Inductive Sensors Catalog	* see page 5 of the Inductive Sensors Catalog
<b>Weight - Cable Output</b>	---	145g
<b>Weight - Connector Output</b>	95g	---

## Inductive AC

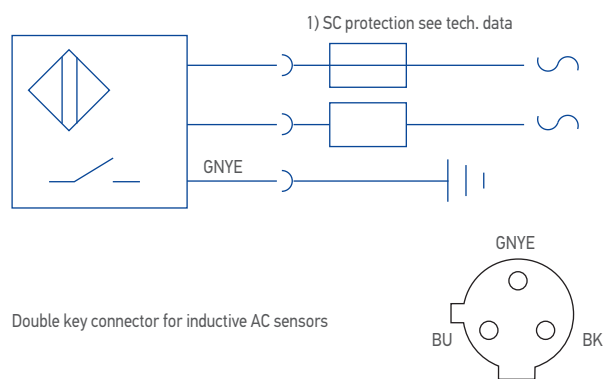



Rev. 13, 12/2020

Product and Company names and logos referenced may be either trademarks or registered trademarks of their respective companies. We reserve the right to make modifications and improvements.

[www.datalogic.com](http://www.datalogic.com)